

N

# APPENDIX A

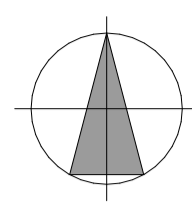

### Key

- Existing Walls
- New Proposed Walls
- Walls to be Demolished

### Occupancy Levels | Gold, Floor 1

- Fixed / Hot Desking**
- 48No. Desks
  - (Based upon a 1600W x 800D desk size).
  - Total: 48No.**
- Agile Working Environments**
- 14No. to Agile Working Environment 1
  - 8No. to Agile Working Environment 2
  - 8No. to Agile Working Environment 3
  - 8No. to Agile Working Environment 4
  - 8No. to Agile Working Environment 5
  - 10No. to Agile Working Environment 6
  - 4No. to Agile Working Environment 7
  - 8No. to Agile Working Environment 8
  - Total: 68No.**
- 20No. to Central Boardroom
  - 10No. to Meeting Room 1
  - 10No. to Meeting Room 2
  - 6No. to Meeting Room
  - Total: 46No.**

**Total Occupancy Level: 162No. Individuals**

The above figures indicate maximum occupancy levels to each space however, levels will fluctuate when in use.

#### Briefing Occupancy Figures

- 50No. spaces allocated to traditional / hot desks.
- 78No. spaces for Agile / Collaborative work zones.

#### General Design + Scope of Works Notes

Note that the above figures do not consider COVID-19 social distancing measures in place and can be advised and undertaken during the next project stage.

During the next project stage, the design team will determine and re-configure the power and data services to suit the new desk layout as well as the agile working environments.

Where new meeting rooms have been proposed to be demolished, mechanical and electrical services would need to be co-ordinated to suit the new layout, re-configured and stripped back where necessary.

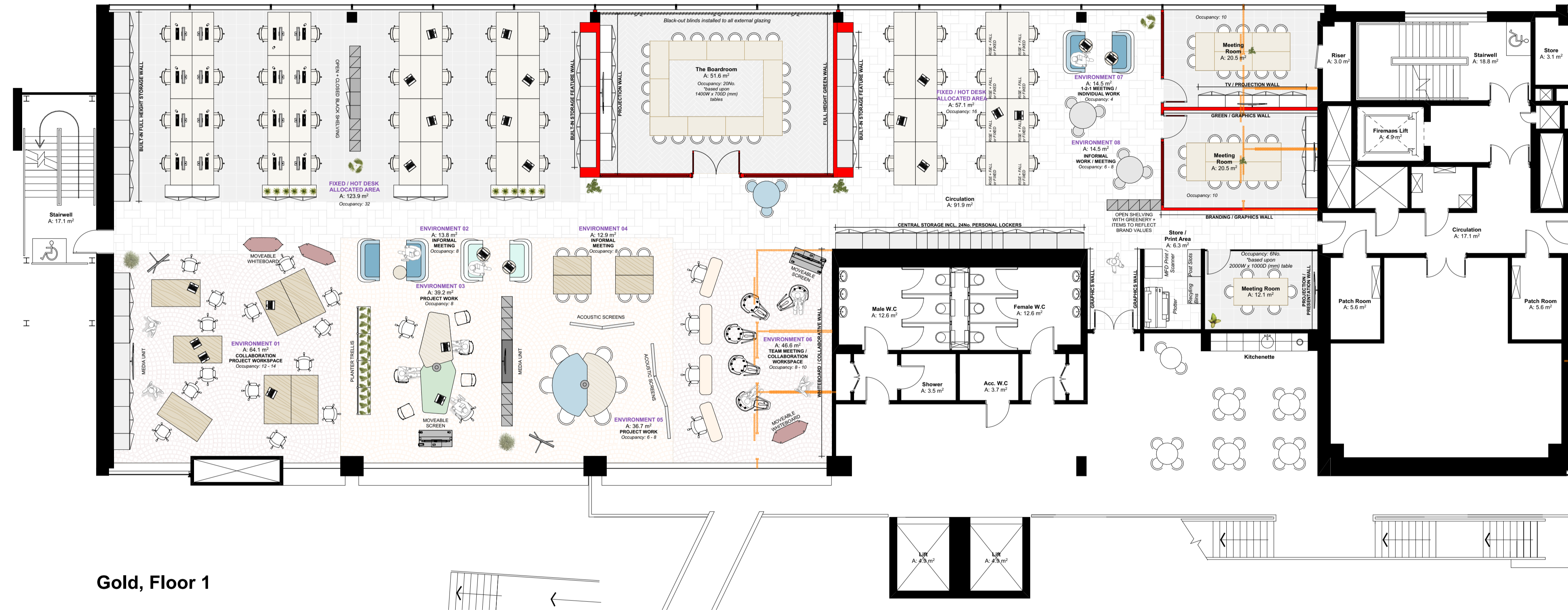

### Gold, Floor 1

The above illustrates an option to demolish 6No. existing glazed meeting rooms and in lieu construct stud partitions to form 2No. larger meeting rooms. This would address individual Meeting Room acoustics. Each Meeting Room features full height glazing with a glazed internal door, providing transparency through the spaces.

**Disclaimer.**  
This drawing is to be read in conjunction with all related drawings. Do not scale from this drawing. All dimensions must be checked and verified on site before commencing any work or producing shop drawings.  
This drawing is copyright and remains the property of Concertus Design and Property Consultants. When reproducing this drawing for any purpose, please ensure that Concertus is attributed clearly by either using the company logo, or as follows 'Image produced by Concertus Design & Property Consultants Limited'.

REV	DATE	BY	DESCRIPTION	CHKD
P1	07.01.2022	KC	First Issue.	BB
P2	24.01.2022	KC	Plan revised to Option 2.	

2 Friars Bridge Road - Ipswich - Suffolk - IP1 1RR

S3-REVIEW & COMMENT	Project	Project Number
	Endeavour House - Space Planning for BMSDC Ipswich	120333
	Drawing Title	Scales
	Gold Floor 1   Developed	1:100
	Proposal	At A1 Size
Lead Designer	Drawn	
Kelly Content	KC	
email: kelly.content@concertus.co.uk	Chkd	
	BB	
	Date	
	01.2022	
	Tel: 07710 920188	

**120333-CDP-ZZ-01-DR-I-0004-P2**  
Project Code - Originator - Volume/System - Level/Location - Type - Role - Number